

A-45-108

P-14-100

59

(shown in charts)
GW U. St Clair
1887

Courses up y^e C^t

S ^o 19 ^o W 64 Ps
S ^o 25 ^o E 56 do
S ^o 75 ^o E 34 do
S ^o 23 ^o E 36 do
N ^o 82 ^o E 32 do
N ^o 10 ^o E 33 do
N ^o 75 ^o E 86 do
S ^o 85 ^o E 46 do
S ^o 7 ^o W 43 do
S ^o 20 ^o E 37 do
S ^o 14 ^o W 25 1/2 do
S ^o 36 ^o W 26 do
N ^o 76 ^o W 20 do
S ^o 68 ^o W 30 do
S ^o 35 ^o E 31 do
S ^o 47 ^o W 14 do
N ^o 52 ^o W 26 do
S ^o 80 ^o W 57 do
S ^o 59 ^o W 36 do
N ^o 58 ^o W 34 do
S ^o 53 ^o W 20 do
784 1/2

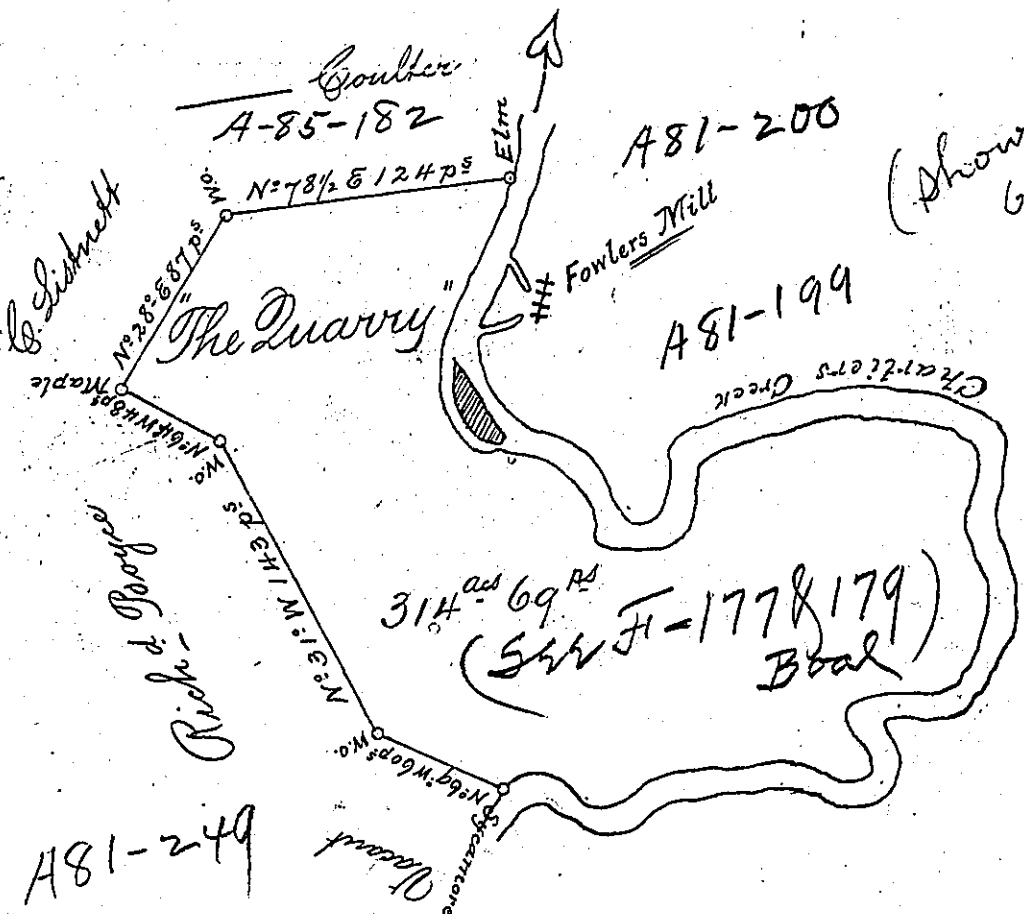

A Draught of a Survey called "The Quarry" situate on Chartiers Creek in Washington County, containing 314 Ac^s 69^{Ps} and the usual allow^{ce} for Highways &c executed Decem^r 22^d 1787 in Pursuance of a Warrant for 300 Ac^s granted to William Wilson by the Hon^{ble} J^{cs} J^{cs} dated April 28th 1785

J^{cs} Lukens Esq. S. Genl

Presley Nevill }
Mathw. Ritchie } J^{cs}

IN TESTIMONY that the above is a copy of the original remaining on file in the Department of Internal Affairs of Pennsylvania, made conformably to an Act of Assembly approved the 16th day of February, 1833, I have hereunto set my Hand and caused the Seal of said Department to be affixed at Harrisburg, this sixth day of May 1902



James W. Fatta
Secretary of Internal Affairs.